

FULL OVERTRAVEL

OPERATING POSITION

FREE POSITION

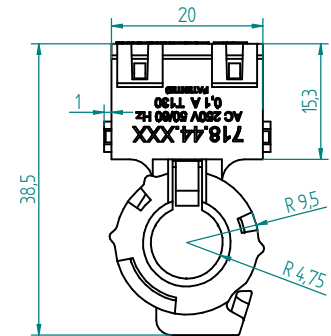
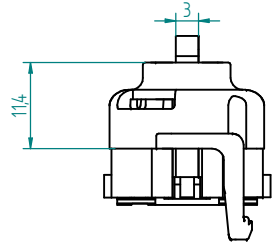

OPERATING FORCE: 650gr. max.
SWITCH BODY: PA 6.6 20-30% GLASSFIBER REINFORCED
CONTACTS: PHOSPHORUS-BRONZE
CABLES: Ø 2.1 mm SILICON 0,5 mm² COPPER
SWITCHING LIFE: >50.000 for each switch
TEMPERATURE RATING: 130 C°
FRONT FACE OF SWITCHES:
 PRODUCT CODE -BRAND -ORIGIN
BACK FACE OF SWITCHES:
 AC 250V 50/60Hz 0,1A T 150

GENERAL TOLERANCES

0-6 mm	±0.25
6-18 mm	±0.35
18-50 mm	±0.5
50-100 mm	±1
100-... mm	±2

All drawing units are mm and without scale

140	140	110	-	-	580	-	980	-	-
A	B	C	D	E	L1	L2	L3	L4	

DATE: 03.11.2014	CONTROL: E.KOCYIGIT	CUSTOMER CODE: -
DRAWING: HÜSEYİN DÜŞÜN		CUSTOMER NAME: -
PRODUCT CODE: 718.44-4.T001	PRODUCT NAME: PUSH TYPE SWITCHBAND 4 PCS. FOR GAS IGNITION	



TERMEL

Makina Sanayi ve Ticaret Ltd. Şti.
 Çavuşoğlu mh. Selviyolu cd. No:8 Kartal
 İstanbul / TÜRKİYE
 Tel: +90 216 389 87 41 - 387 26 03
 Fax: +90 216 374 59 21
 E mail: info@termel.com.tr